

www.luxalon.com

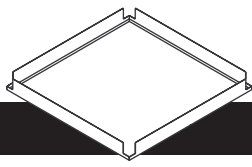



SYSTEM OVERVIEW CLIP-IN 3MM BEVEL



SHORT SYSTEM DESCRIPTION

The Luxalon® Clip-In tile system has a bevelled edge to form visually closed joints. The 3 mm bevel option will emphasise the crispness of the tile ceiling design with fine jointlines. Luxalon® Clip-In tiles are available in a wide variety of pre-defined rectangular module sizes that are commonly used in ceiling design. Simple notches in the longitudinal tile-edges, enable each tile to be clipped into a concealed Luxalon® grid system. There is one universal Clip-In profile available for, both the primary and secondary support structure.

PRACTICAL APPLICATION AREAS;

- Perimeter tiles are cut into an edge cover profile offering tight closed joint details and making the Luxalon® Clip-In tile systems ideal for areas related to hygiene
- The concealed suspension provides self-levelling of each tile, resulting in a smooth ceiling surface
- The combination of standard perforation patterns and non-woven tissue ensures superior sound absorption

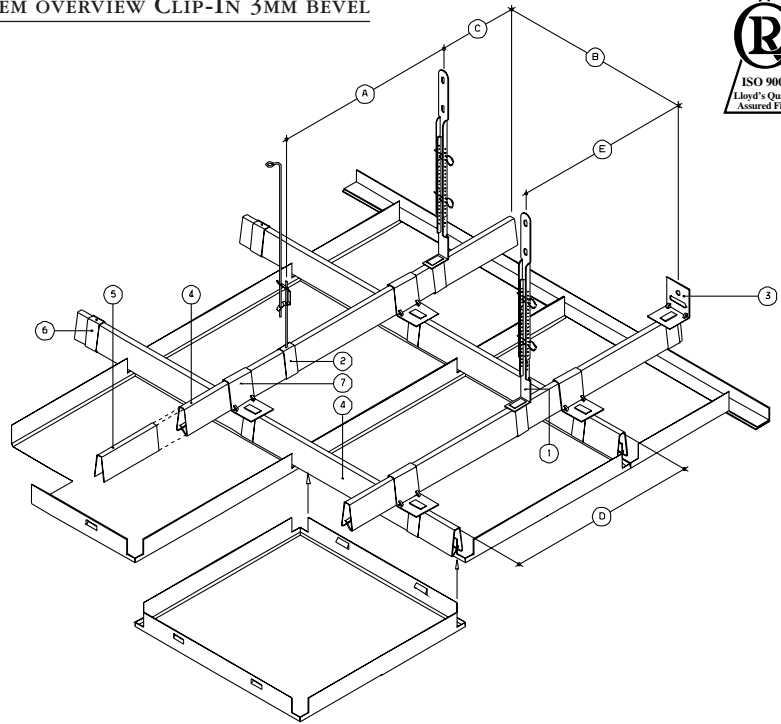

1. Hanger/ Nonius
2. Hanger/ Rod
3. Wall Clamp
4. Primary/secondary Clip-In Profile
5. Clip-In Profile Splice
6. End Clamp
7. Cross Connector

- A = 1250 mm (max.)
- B = 1200 mm (max.)
- C = 250 mm (max.)
- D = Tile size (max.)
- E = 1250 mm (max.)

DIMENSIONS

CLIP-IN 3 MM BEVEL
"TILE-OPTIONS"

Module in mm	Gauge: steel	Alu.
600 x 600	0.5	0.6
625 x 625	0.5	0.6
300 x 600	0.5	0.6
312.5 x 625	0.5	0.6
300 x 1200	0.5	0.6

CLIP-IN 3 MM BEVEL
"SWING DOWN"

Module in mm	Gauge: steel	Alu.
600 x 600	0.6	0.6
625 x 625	0.6	0.6

STANDARD CONSTRUCTION DETAILS

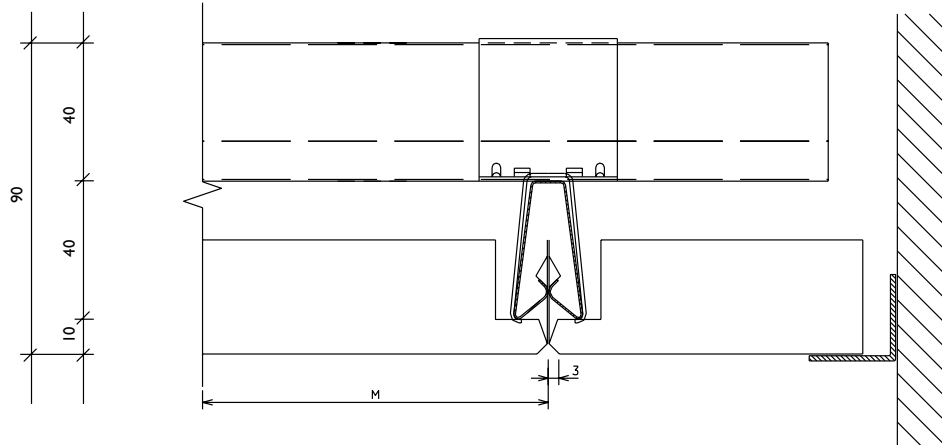

MATERIAL REQUIREMENT PER M²

Components	Unit	600x600	625x625
Tiles	pcs	2,78	2,56
Clip-In Rail	m1	2,50	2,43
Rail Connector	pcs	1,39	1,34
Rail Splice	pcs	0,50	0,49
Suspension	pcs	0,67	0,67

DOWNWARD ACCESSIBILITY

Although installed to a concealed grid system, each panel can be removed individually. Individual tiles can easily be released from the grid-profiles with a simple tool that is inserted between adjacent tiles on both edges combined with downward pressure.

For frequent accessibility, Swing-Down Clip-In tiles can be included in the ceiling design. These access tiles are self-locking and self-locating, and they are released with minimal effort.

ACOUSTIC PERFORMANCE

In order to improve interior sound control, the Luxalon® Tile and Plank programme can be perforated in a range of standard patterns with open areas between 16% and 60%. These patterns are framed with a solid border of 10 mm in order to assure maximum flatness and product stability. As a standard feature, perforated tiles can be supplied with a sound absorbing non-woven tissue glued into the tile for enhanced acoustical performance.

SOUND ABSORPTION

CURVE 1

2.5 mm Ø perforated tiles, 20 mm thick mineral wool pad with a density of approx. 20 kg/m, plenum depth 200 mm.

CURVE 2

2.5 mm Ø perforated tiles, non-woven acoustic felt, plenum depth 200 mm.

CURVE 3

1.5 mm Ø perforated tiles, 40 mm thick mineral wool pad with a density of approx. 20 kg/m, plenum depth 200 mm.

All curves tested according to DIN 52215, BS 3638 and ISO 354.

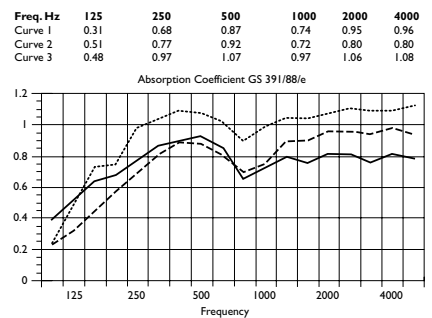

TYPICAL SOUND ATTENUATION

Frequency (Hz)	Normalised Level Difference					
	125	250	500	1000	2000	3150
Plain + Acoustipanel	35.0	37.7	45.9	50.8	58.7	61.3 dB
Microperforated Tile + Mineral Wool 80 kg/m ³ (40 mm thick) + Backing plate	23.2	25.1	44.7	55.5	62.7	67.3 dB

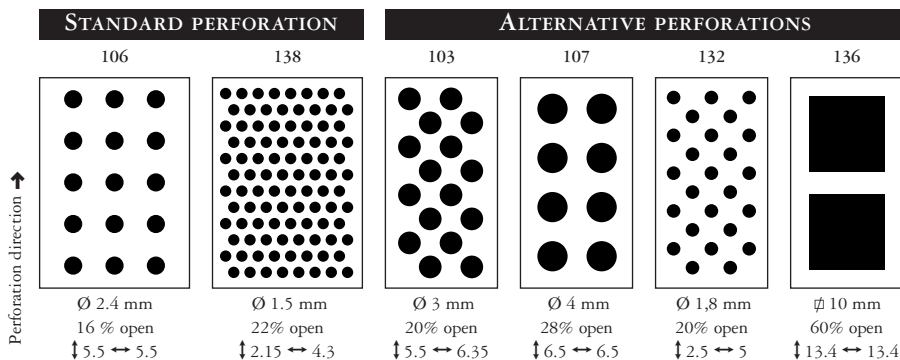

Note: Perforated products have a nominal plain border of 10 mm.

LUXALON®
ARCHITECTURAL PRODUCTS

MATERIAL SPECIFICATIONS

- BASE MATERIAL

Luxalon® Clip-In tiles are available in electrolytic-galvanised steel, phosphatised and chemically treated in accordance with high industrial standards (DIN 1541/BS 1449, part 1:1983/TAIM standards). Zinc coating is double sided and 2.5 microns. Aluminium alloy AL 99.5RA, 3/4 hard (according to DIN 1783) or stainless steel alternatives are also possible, when required.

- COATING

The tough and durable polyester powder-coating finish in a minimal thickness of 60 microns, is electrostatically applied ensuring uniform coating thickness, absolute adhesion, maximum resistance to abrasion. Because Luxalon® coatings are applied after perforation and bending process, exposed edges are protected. Standard gloss rate is 15 - 20% at 60° angle of incidence.

- COLOUR RANGE

The standard colours range includes a range of whites and a metallic silver colour. Any other RAL, BS or NCS colour is available on request.

Standard Colour Range

RAL 9001 white
RAL 9002 white
RAL 9016 white
RAL 9010 white
RAL 9006 silver

- TOLERANCES

As a member of the Technical Association of Industrial Metal Ceiling Manufacturers (TAIM), Hunter Douglas complies with tolerance criteria as specified in chapter 4 of the TAIM Quality standards for metal. The TAIM standards are available on request.

- FIRE BEHAVIOUR

Suspended Luxalon® metal ceilings are classified incombustible, and will therefore not contribute to possible fires. When ceilings however need to protect the structural integrity of a building, Luxalon® ceilings offer a wide range of practical solutions with regards to fire resistance and fire stability. Further information is available on request.

SPECIFICATION TEXTS

PART 1. GENERAL

1.1 INTRODUCTION

Supply and fix Luxalon® Clip-In Tile Ceiling System as manufactured by Hunter Douglas Architectural Products.

1.2 DESCRIPTION OF THE SYSTEM

The system will consist of bevelled edged tiles fixed to an adjustable suspension system which allows removable tiles to clip in place.

PART 2. PRODUCT

2.1 TILES

___ m² Luxalon Clip-In Tile Ceiling consisting of :

___ x ___ tiles made of 0.5 mm steel or 0.6 mm aluminium.

___ x ___ swing-down tiles made of 0.6 mm steel

Two sides of each tile will be raised and pipped and stopped to ensure positive engagement into the spring tee yet allow for demounting of individual tiles. All tiles will be bevelled edged in bevel size 3 mm.

2.2 PRIMARY SUSPENSION

Rows of 0.5 mm galvanized steel common profiles shall be installed at 1200 mm centres by means of ___ mm high rod hangers or nonius hangers fixed to the upper structure at a maximum distance of 1250 mm centre to centre. Primary suspension profiles will be fixed at both ends to the wall to prevent upward movement.

2.3 SECONDARY SUSPENSION

Luxalon® Clip-In profiles shall be fastened to the primary suspension by means of cross connectors at the correct distance to support the tiles.

PART 3. ADDITIONAL SPECIFICATIONS

3.1 EDGE COVER PROFILES

L-profile 25 x 25 mm, made of 1.5 mm thick aluminium.

W-profile, 25 x 25 x 25 x 25 mm, made of 1.5 mm thick aluminium.

F-profile, 25 x 25 mm, made of 1.5 mm thick aluminium.

Stepped F-profile, 25 x 25 x 25 x 25 mm, made of 1.5 thick aluminium.

3.2 PERFORATIONS

Manufacturer shall supply tiles with perforation pattern no. _____ with a nominal 10 mm plain border on all sides.

Perforations will have a _____ diameter hole resulting in a _____ % open area. Other borders on request.

3.3 ACOUSTICS

Manufacturer shall supply acoustic non-woven textile, thickness 0.2 mm glued into the tiles or black faced PE wrapped mineral wool thickness ___ mm density ___ kg/m³ and of a size to completely fill the tile.

3.4 COATING

Architect will make a colour selection from the standard Hunter Douglas colour range for Luxalon® Tiles RAL code no. ___ or a special colour will be made to match ___.

The coating will consist of a durable polyester powdercoat finish in a minimal thickness of 60 microns, electrostatically applied onto electro-galvanised steel, phosphatised and chemically treated according to high industrial standards (DIN 1541/ TAIM standards).

3.5 INSTALLATION

All materials shall be installed in strict compliance with all local codes, ordinances and manufacturer's recommendations including specific additional requirements as may be called for in the specifications or shown on the drawings.

3.6 SUBSTITUTIONS

Ceiling installers wishing to submit proposals on systems other than the Luxalon® Tile Ceiling System shall, at least 10 days in advance of the bid date, submit to the architect complete descriptive information of the total system concept and performance data tests made as a system. In addition include a list of similar installations of the proposed substitution. If approval is made an addendum will be issued enumerating such approved system as herein set forth.

LUXALON® CEILING SYSTEMS

Unit 7 & 8 Keys Business Park - Keys Park Road - Hednesford - WS12 5GW

Tel. (01543) 273620 - Fax (01543) 270084 - e-mail: luxalon-ceilings@hunter-douglas.co.uk - www.luxalon.com

©Registered trademark - a HunterDouglas® product Pats. & Pats. Pend. - Technical data subject to change without notice. MX663QW0
©Copyright HunterDouglas® 2003. No rights can be derived from copy, text pertaining to illustrations or samples. Subject to changes in materials, parts, compositions, designs, versions, colours etc., even without notice.

LUXALON®
ARCHITECTURAL PRODUCTS

